



PAX A80 Setup and User Guide

2023



Table of contents

1. A80 box contents	2
2. A80 terminal details.....	3
3. A80 batteries	5
4. Network configuration	6
5. Checking IP connection settings	14
6. Viewing software version	15
7. Downloading software/firmware	16
8. Downloading configuration	18
9. Contact us	20

1. A80 box contents

Each A80 is supplied with the following items:

- 1 x A80 terminal
- 1 x Terminal back lid
- 1 x AC/DC power adapter body
- 1 x AC/DC power adapter head for Europe
- 1 x AC/DC power adapter head for UK
- 1 x AC Adapter
- 1 x Paper roll

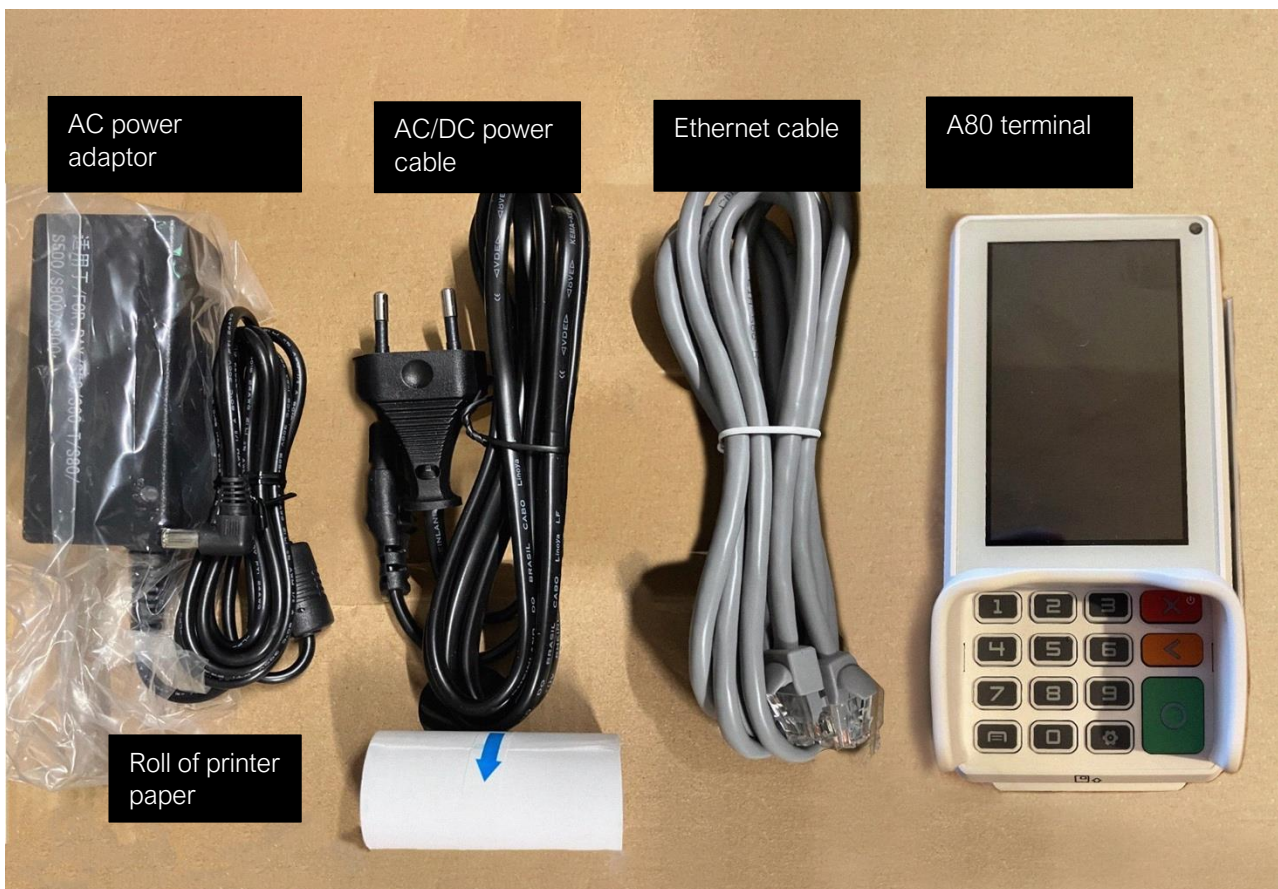

*Note Ethernet cable must be ordered separately.
It does not come in the box.

2. A80 terminal details

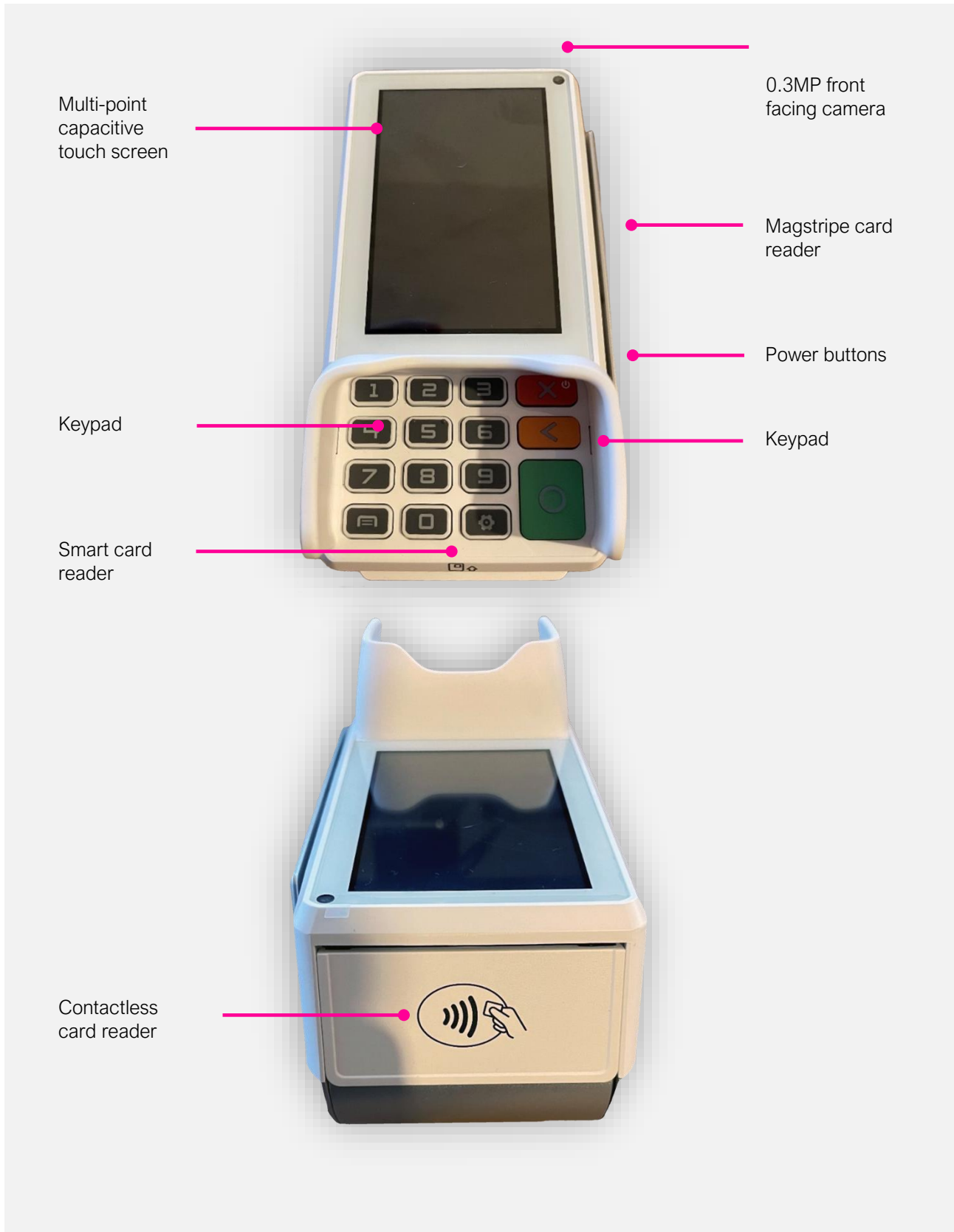

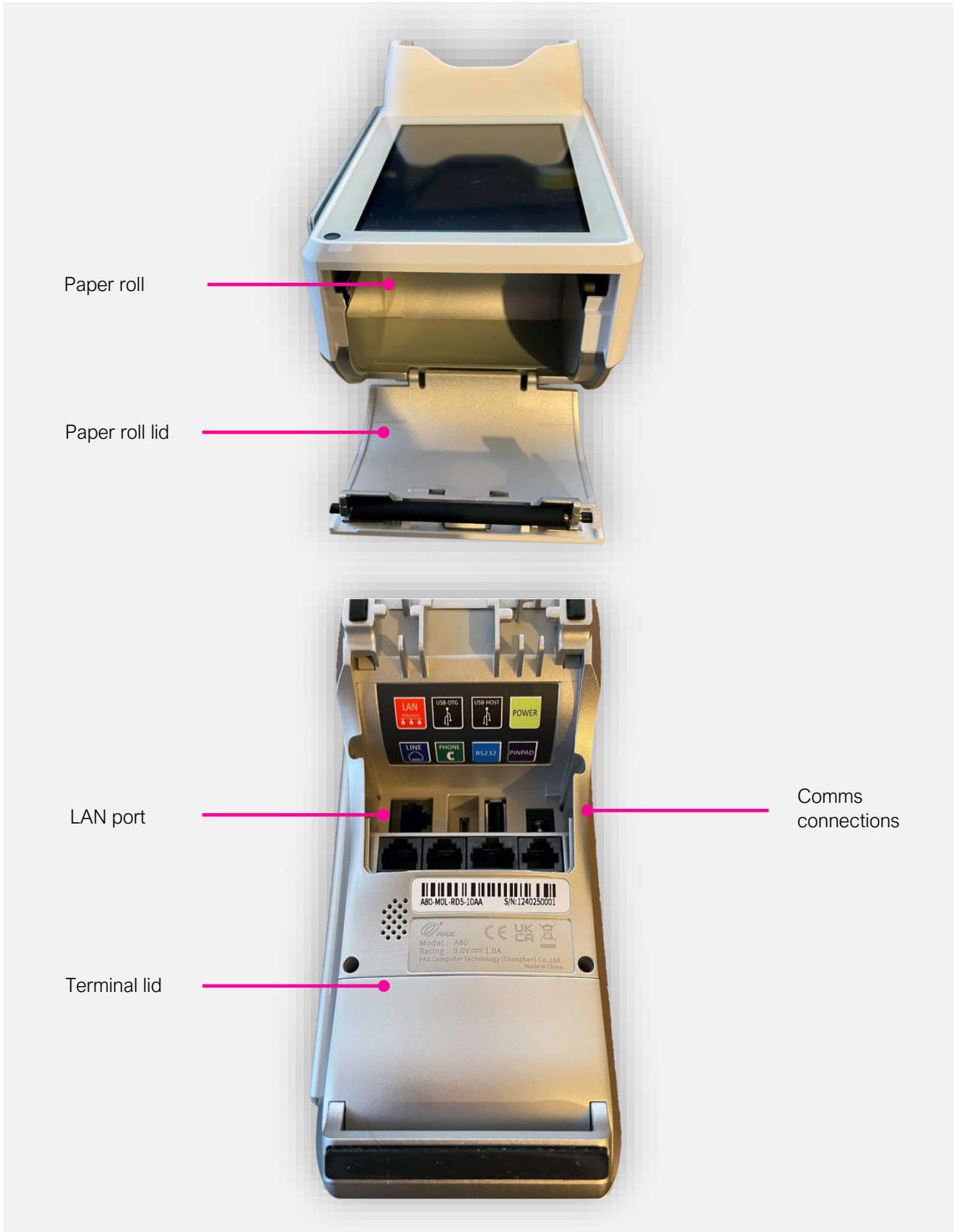

3. A80 batteries

The A80 terminal can support batteries, which need to be ordered via Logistics or directly via Secure Retail.



*Additional A77 batteries can be purchased.

4. Network configuration

Ethernet (LAN)

Before setting up the Ethernet (LAN) connection, you must connect an Ethernet cable into the LAN port on the back of the terminal.

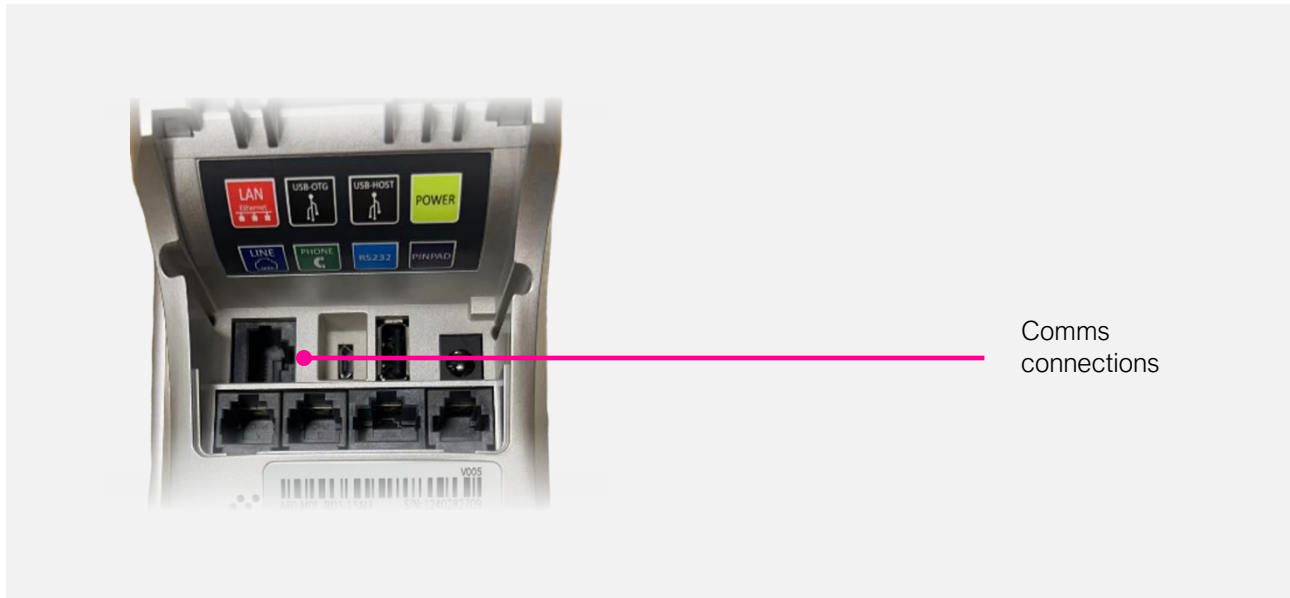

1. To enter the IntegraTE_Pax menu, you will need to press and hold the 'Planet' icon at the top of the screen.
2. When "Please Enter Password" is displayed, enter password and press the green Enter button.
3. Then, select "Config/Configuration".
4. Next, select "Network".

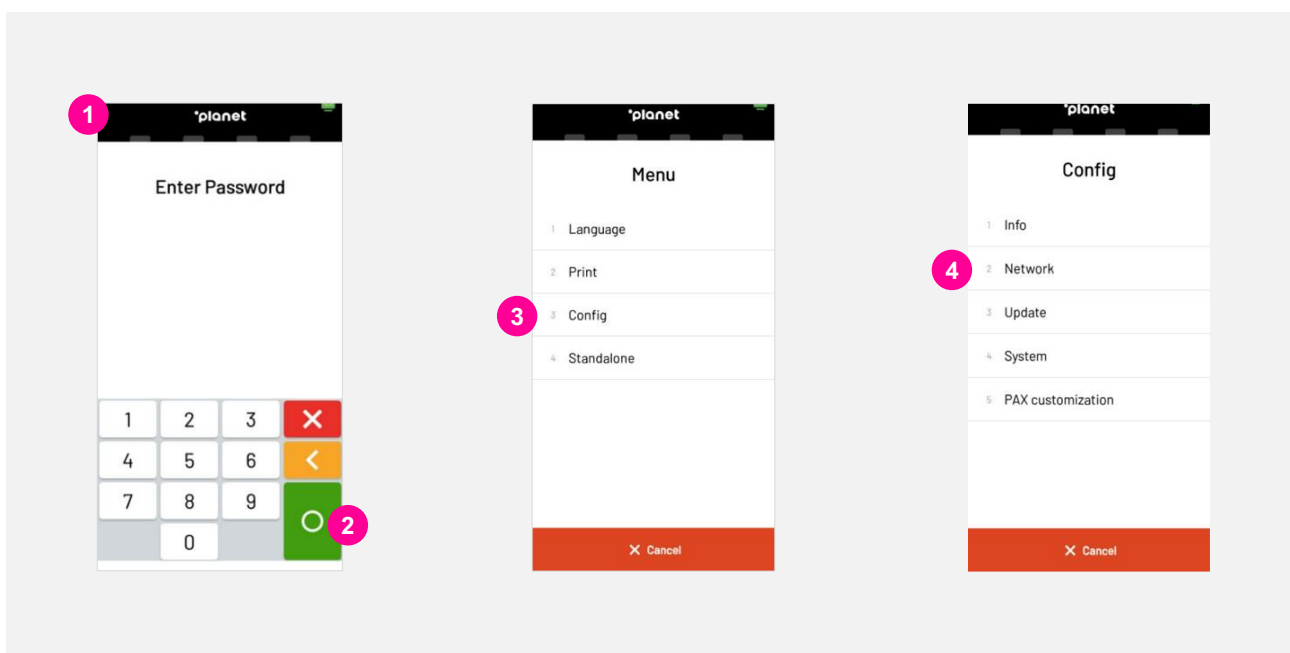

5. Now, select “LAN”.
6. Select Enable.
7. In the settings you will see Ethernet as ‘disconnected’. You need to select Ethernet. This will take you to the Ethernet settings.

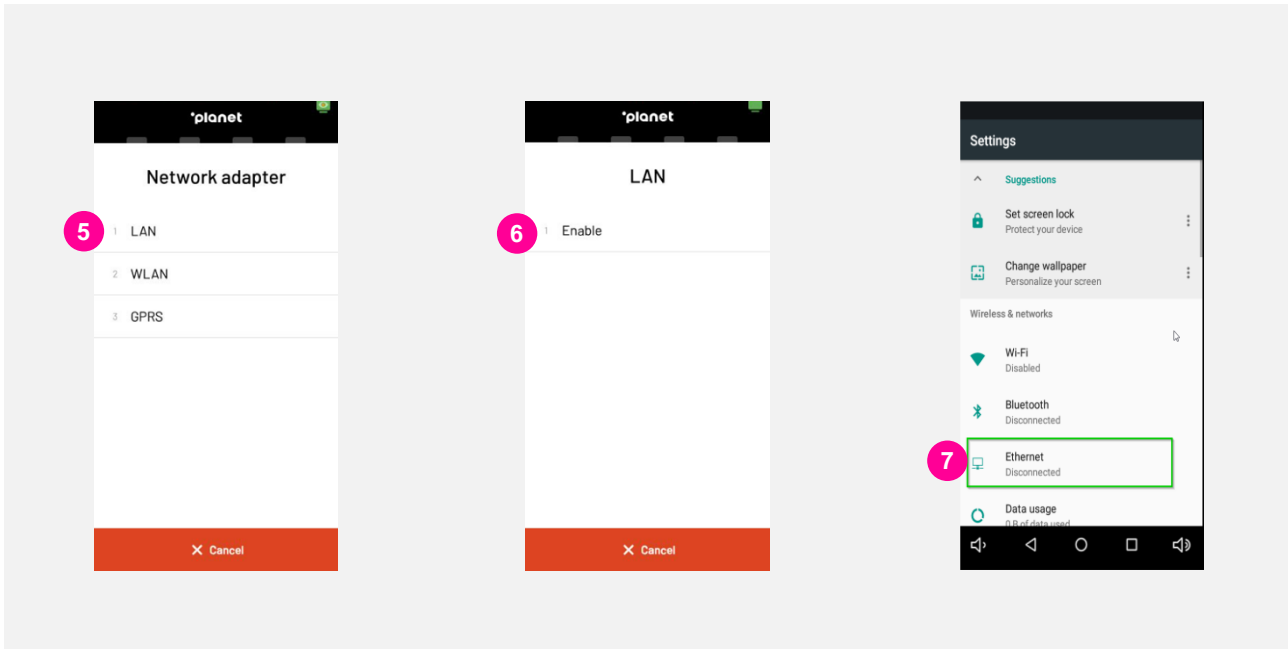

8. To enable Ethernet, you will need to toggle/Enable Ethernet

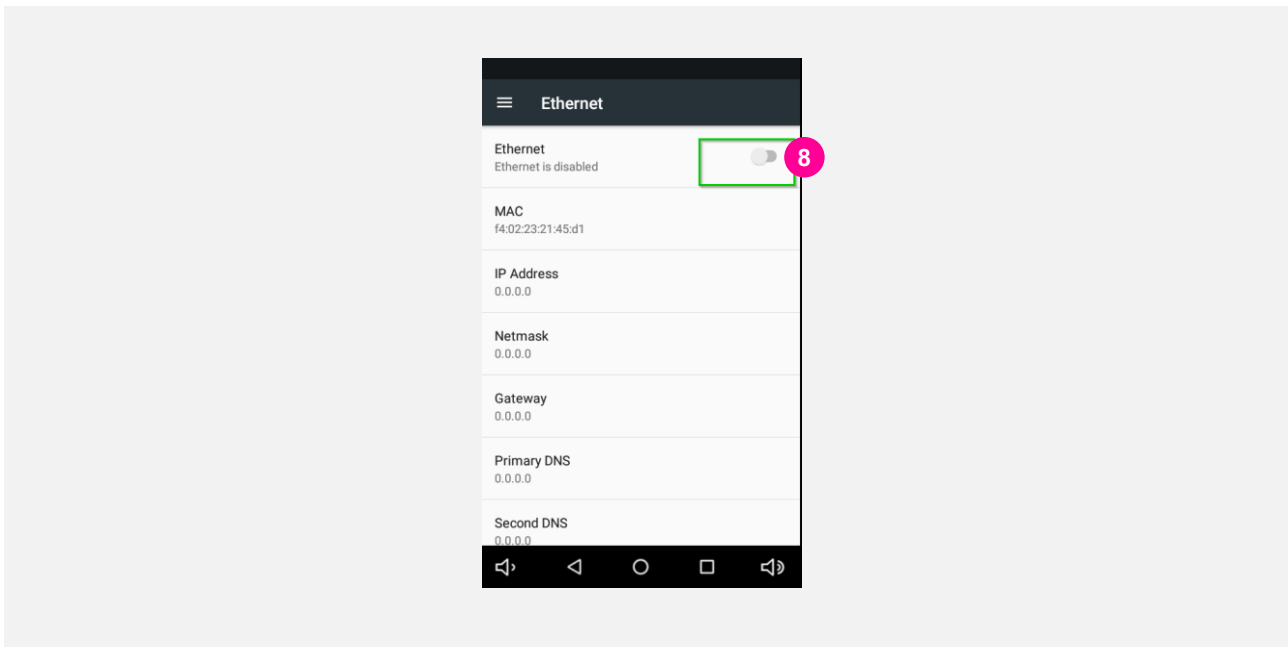

Choosing between Static and DHCP

You will be taken to the following screen where you can see what IP address the terminal picked up by Default DHCP Settings and toggle between DHCP or Static.

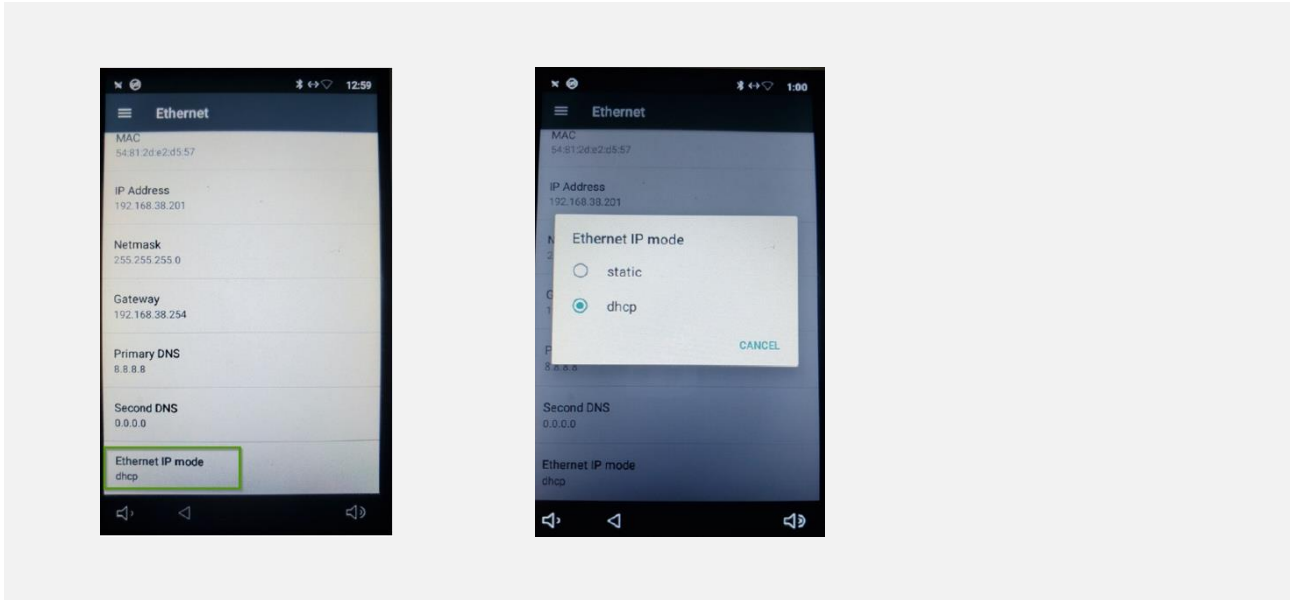

Static IP address configuration.

Upon selecting 'Static', the terminal will bring up a screen where the user must enter the following information:

- IP address
- Gateway
- DNS 1
- DNS 2
- The network prefix length should be left as 24 (default) unless advised otherwise

Once all information is entered, select 'CONNECT'.

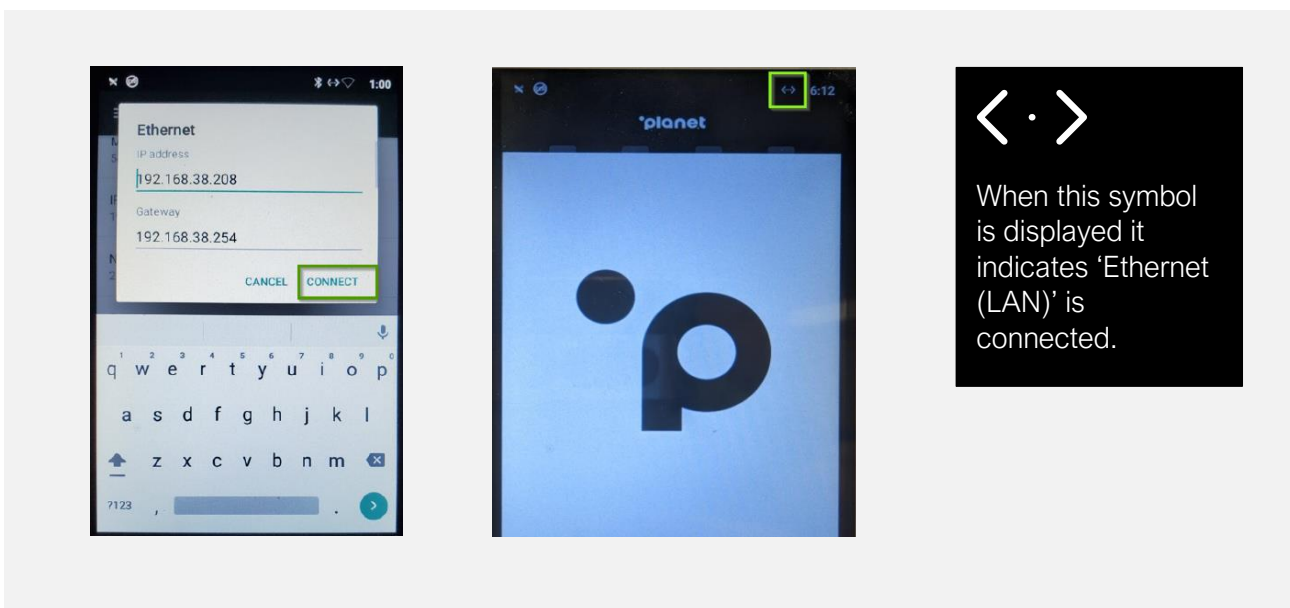

Wi-Fi Setup - (DHCP)

1. To enter the IntegraTE_Pax menu, you will need to press and hold the 'Planet' icon at the top of the screen.
2. When "Please Enter Password" is displayed, enter password and press the green Enter button.
3. Then, select "Config/Configuration".
4. Next, select "Network".

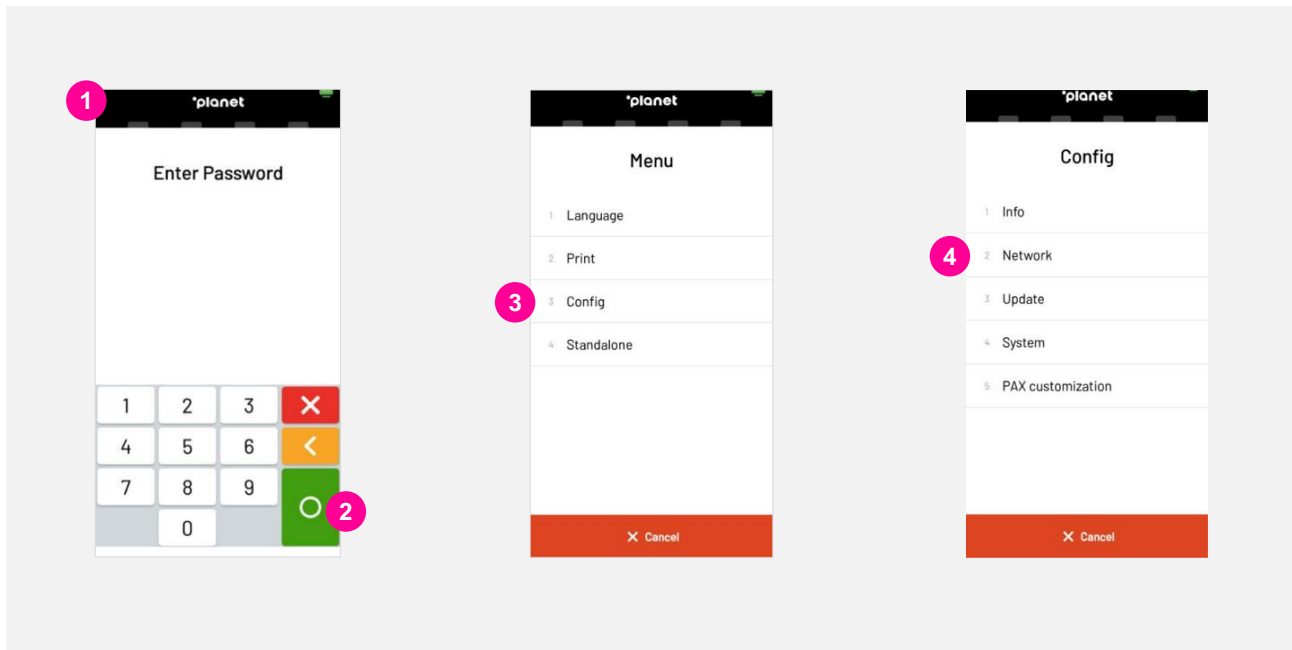

5. Now, select "WLAN".
6. Select "Config".

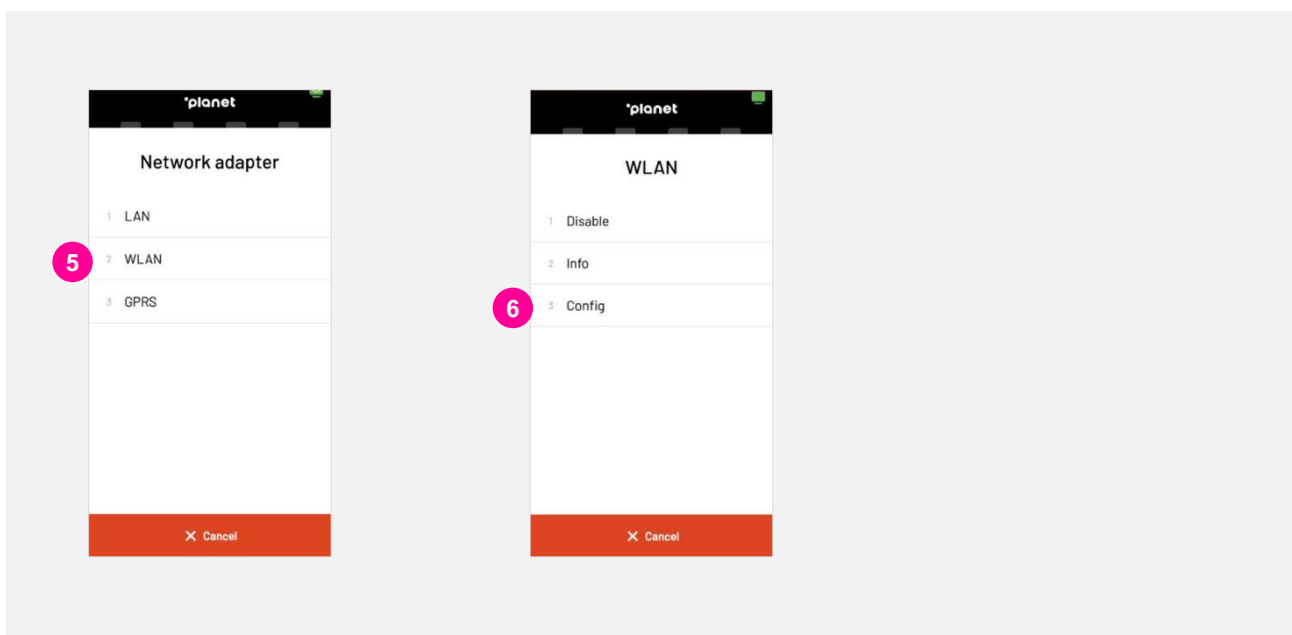

At this stage, Android will take over and you will see the following screen.

7. Ensure the “Wi-Fi” option is set to “On”. The terminal will display all available Wi-Fi networks.
8. At this stage, select the Wi-Fi network of your choice.
9. When prompted, enter your Wi-Fi network password.
10. Then press “Connect” once you’ve entered your Wi-Fi password.

The terminal will display “Connected” underneath the chosen Wi-Fi network if the authentication process was successful.

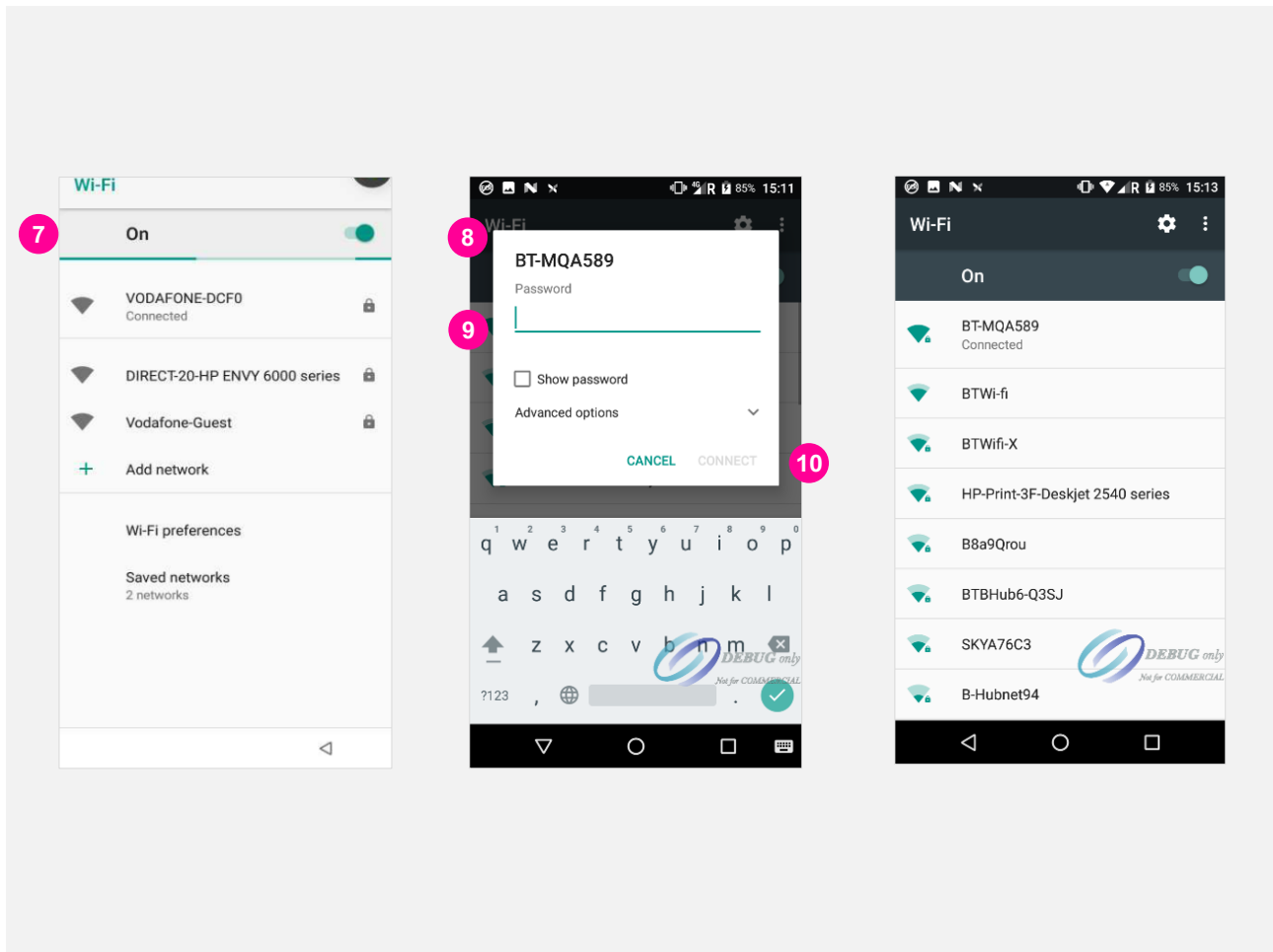

Wi-Fi Setup - (Static)

1. To enter the IntegraTE_Pax menu, you will need to press and hold the 'Planet' icon at the top of the screen.
2. When "Please Enter Password" is displayed, enter password 1235789 and press the green Enter button.
3. Then, select "Config/Configuration".
4. Next, select "Network".

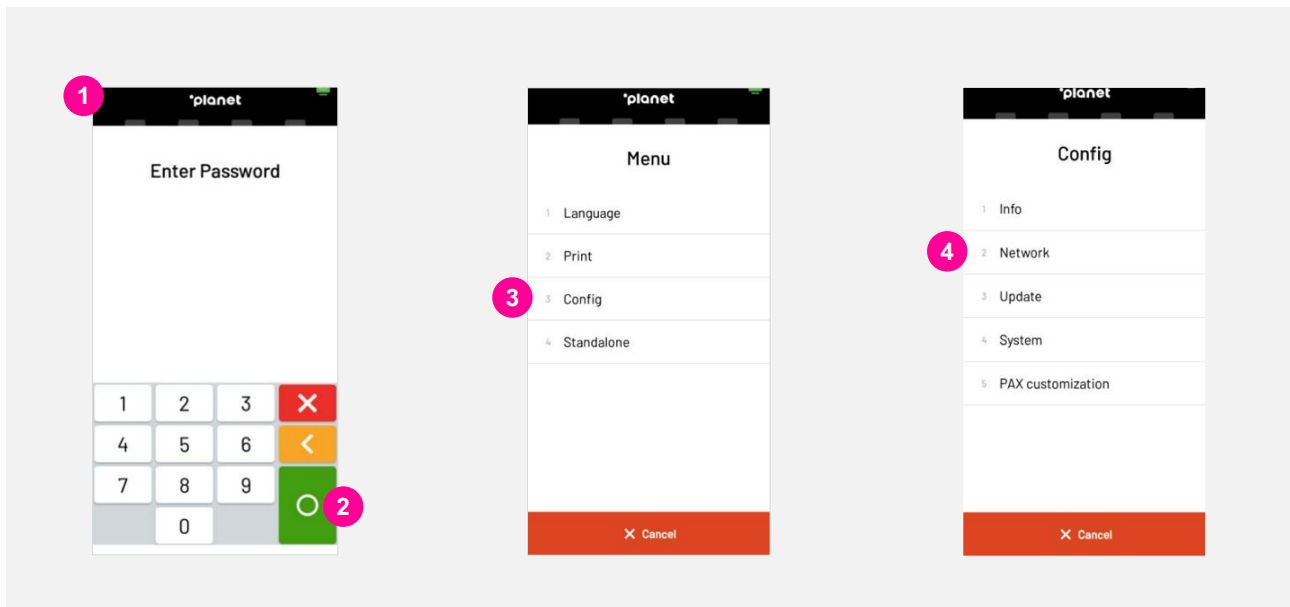

5. Now, select "WLAN".
6. Select "Config".

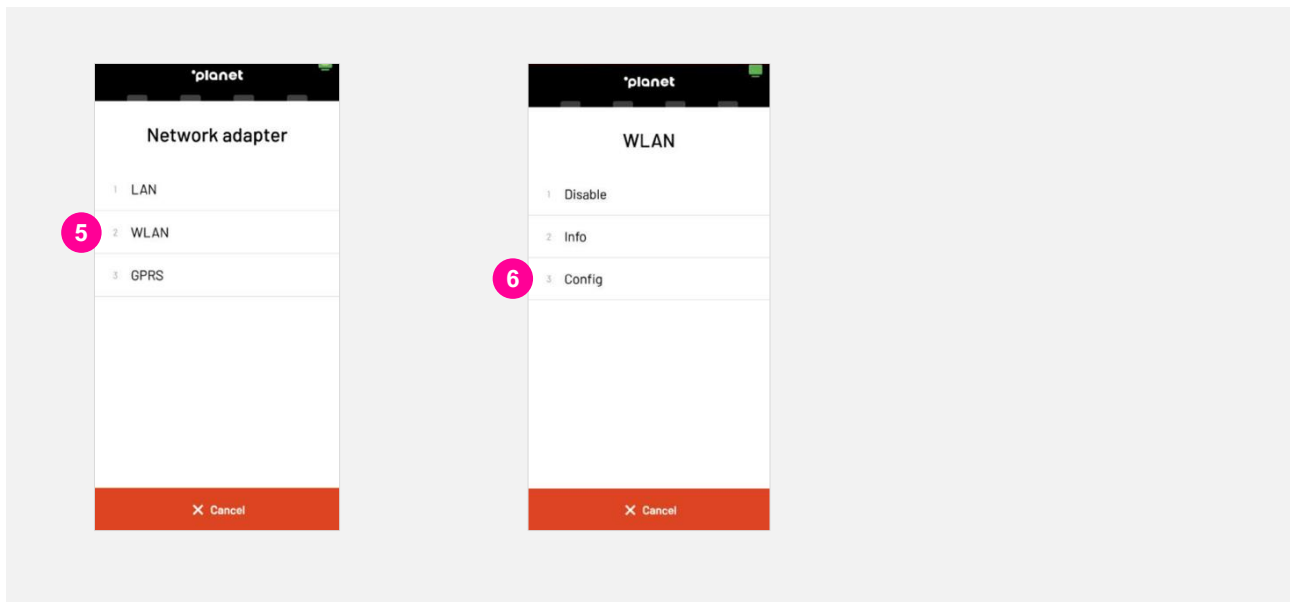

At this stage, Android will take over and you will see the following screen.

7. Ensure the “Wi-Fi” option is set to “On”. The terminal will display all available Wi-Fi networks.
8. Then, select “Add Network” at the bottom of the screen.
9. When prompted, enter the network name of your Wi-Fi network.
10. Next, select “Security”.

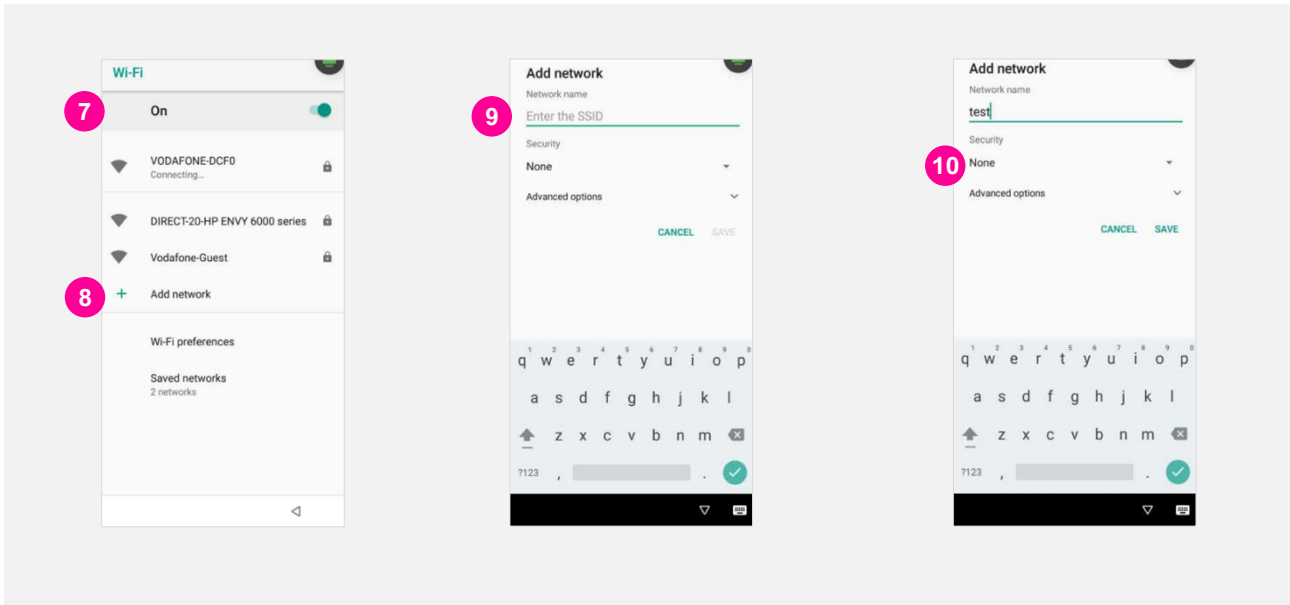

11. From the dropdown list, select the security type related to your Wi-Fi network.

From a Security perspective Planet recommend using WPA/WPA2 PSK

12. Then, enter the Wi-Fi password.

Select the “Show Password” option should you wish to view the password being entered.

13. Now, select “Advanced Options”.

14. IP Settings choose “Static”.

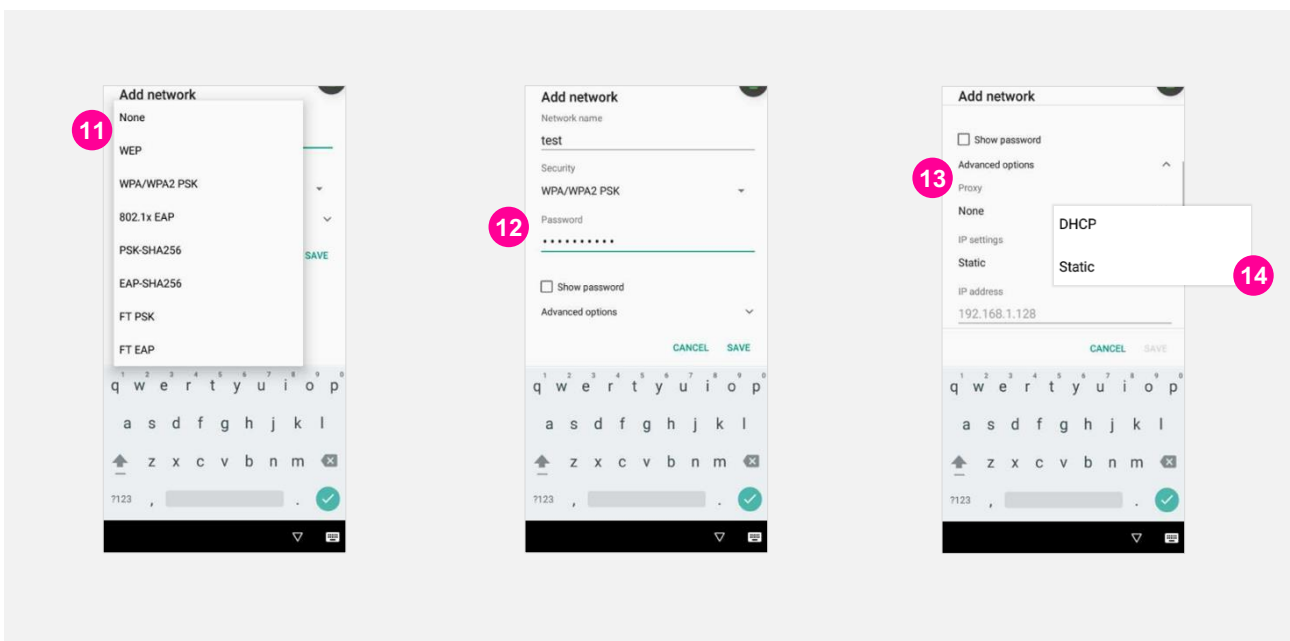

15. When prompted, enter the following information:

- IP Address
- Gateway IP Address
- Network Prefix Length (if applicable)

Scroll down using the bar on the right-hand side of the screen to reveal further options.

16. When prompted, enter the following information:

- DNS 1
- DNS 2

17. Then, when all details have been entered, press “Save”.

The terminal will display “Connected” underneath the chosen Wi-Fi network if the authentication process was successful.

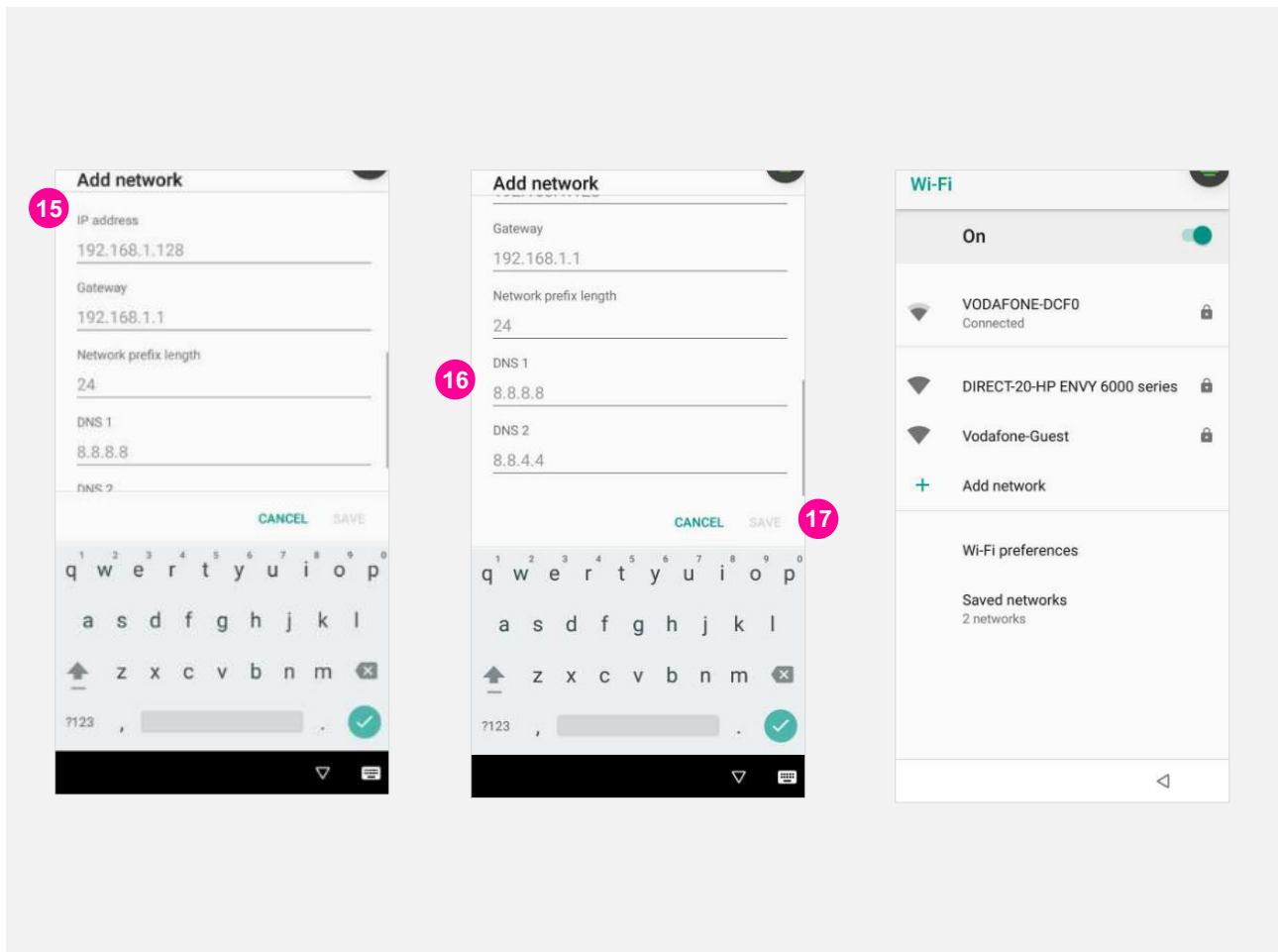

5. Checking IP connection settings

1. To enter the IntegraTE_Pax menu, you will need to press and hold the 'Planet' icon at the top of the screen.
2. When "Please Enter Password" is displayed, enter password and press the green Enter button.
3. Then, select "Config/Configuration".
4. Next, select "Network".

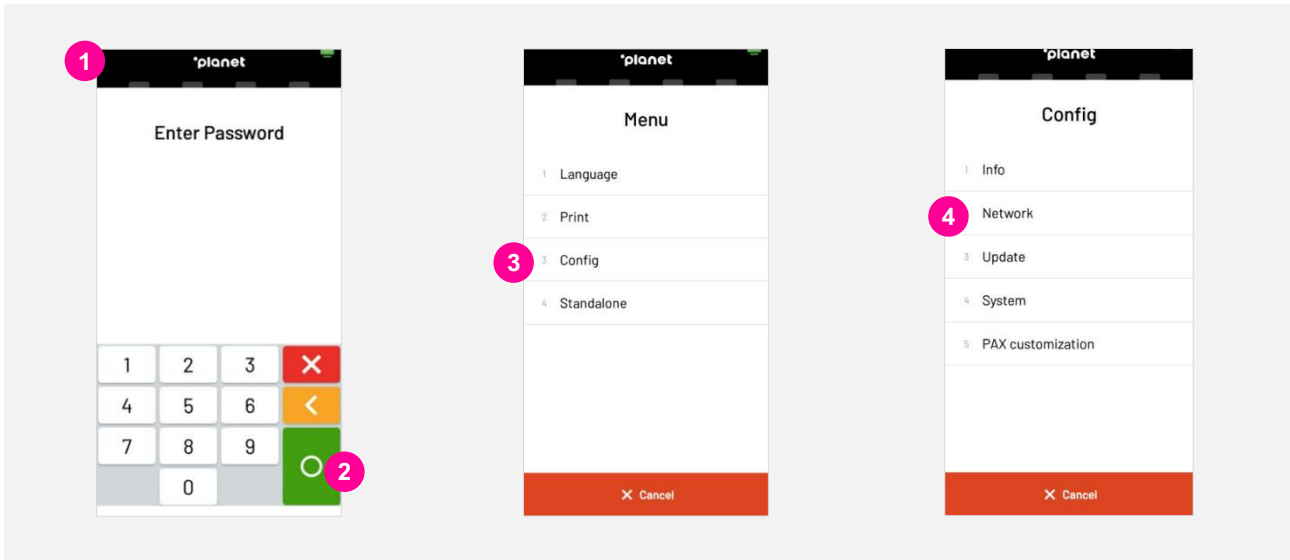

5. Now, select: **WLAN** – If WIFI is enabled. **LAN** – If Ethernet (LAN) is enabled. **GPRS** – If GPRS is enabled.
6. Select "Info".
7. The following information will be displayed:
 - DHCP/Static
 - IP Address
 - Subnet Mask
 - Default Gateway IP Address
 - DNS 1
 - DNS 2

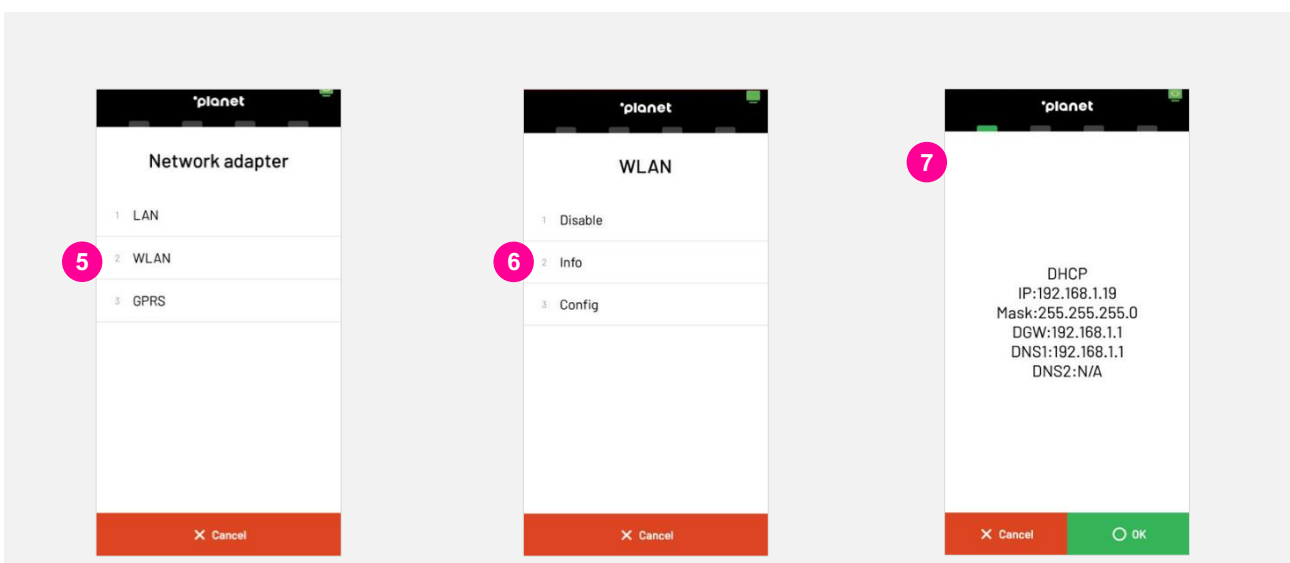

6. Viewing software version

1. To view the Software version on your terminal you will need to enter the IntegraTE_Pax menu, you will need to press and hold the 'Planet' icon at the top of the screen.
2. When "Please Enter Password" is displayed, enter password and press the green Enter button.
3. Select "Config/Configuration".
4. Then, select "Info".

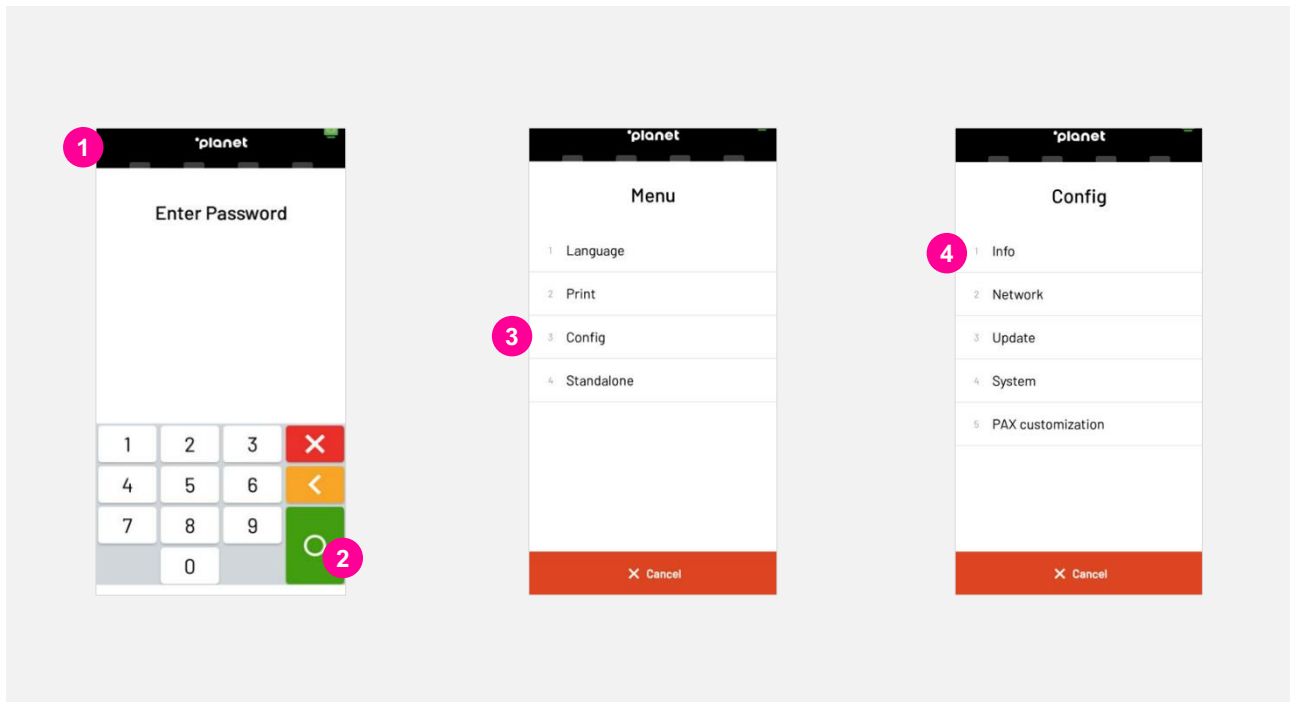

5. The relevant software version will be displayed, along with the Terminal ID and Hardware ID

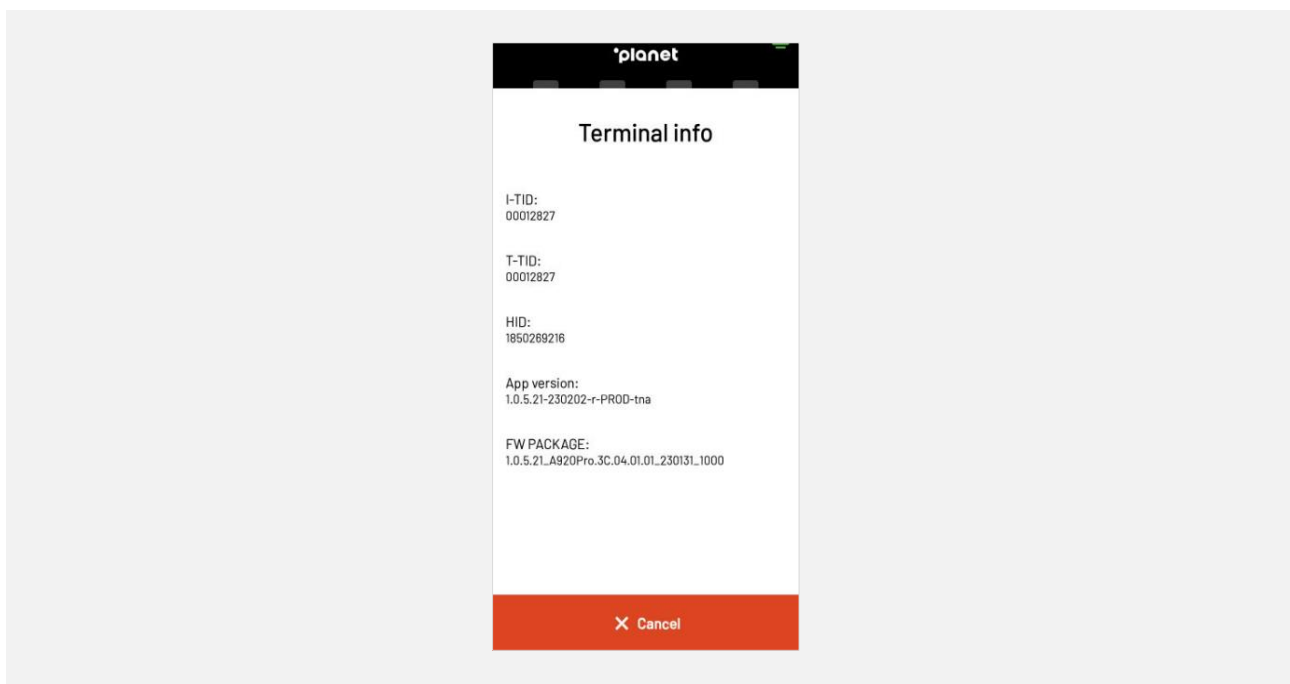

7. Downloading software/firmware

1. To complete a software/firmware download you need to enter the IntegraTE_Pax menu, you will need to press and hold the 'Planet' icon at the top of the screen.
2. When “Please Enter Password” is displayed, enter password and press the green Enter button.
3. Select “Config/Configuration”.
4. Select “Update”.

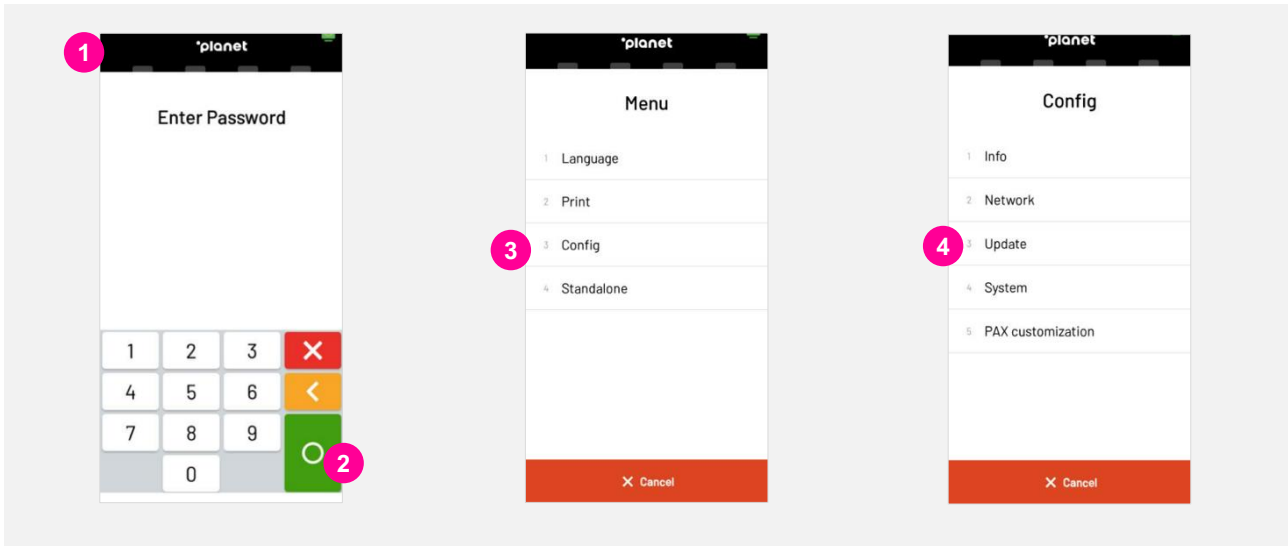

5. Select “Firmware”.
6. The user must then verify that the information on the “Enter the TMS IP/DNS” and “Enter the TMS port” screens match the information shown below.

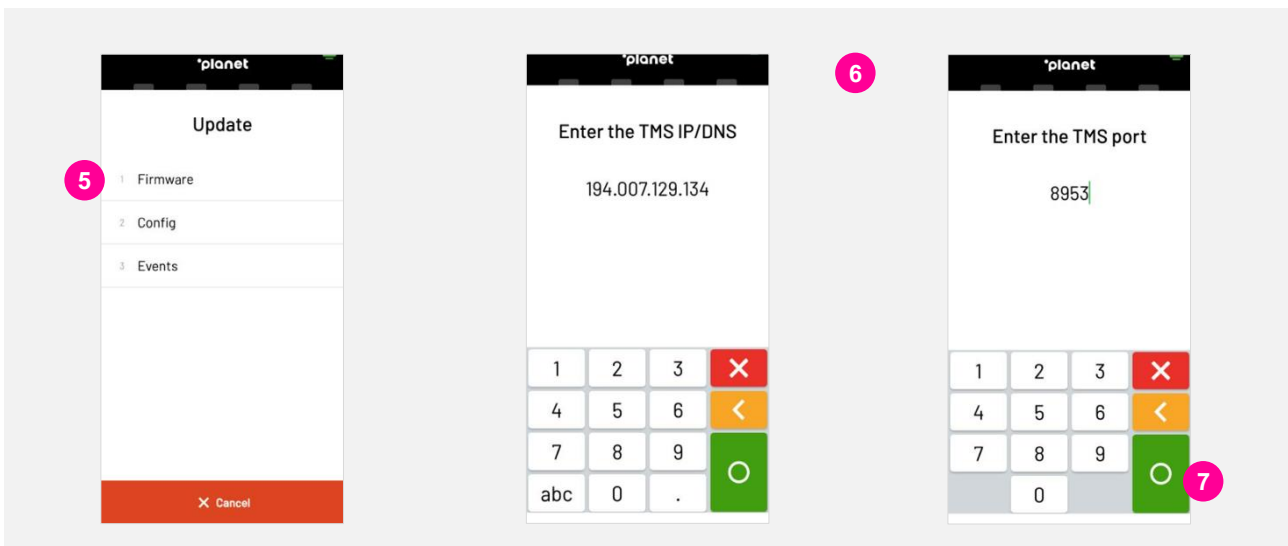

7. Assuming the information matches, the user can proceed by tapping the green “Enter” button on both screens.

***TMS IP depending on a use case. In production we have 194.7.129.134 for global use, and 065.216.73.214 as alternative in the US. The TMS Port is 8953 for Global and US use.**

8. This will take you to the “Enter TMS TID” screen.

9. On the “Enter TMS TID” screen, the user must enter the unique terminal ID provided by Planet. This ID will consist of 8 digits. **There is only ONE TMS TID per pin pad.**
10. Once entered, the user must confirm by tapping on the green “Enter” button.
11. The terminal will now perform the “Firmware download in progress xx%”
12. Should no firmware be available the terminal will display “no new firmware available”

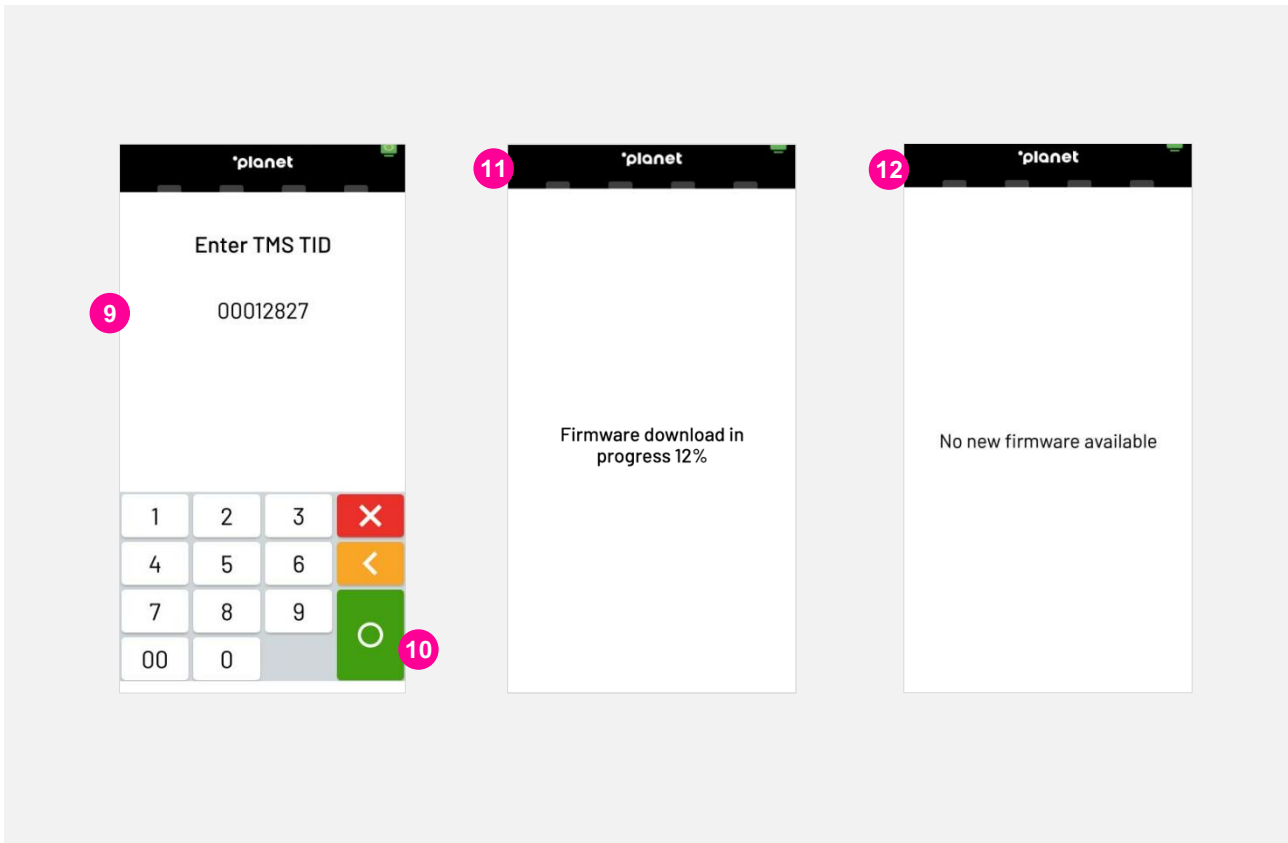

8. Downloading configuration

1. To complete a configuration download the user will need to enter the IntegraTE_Pax menu, you will need to press and hold the 'Planet' icon at the top of the screen.
2. When "Please Enter Password" is displayed, enter password and press the green Enter button.
3. Select "Config/Configuration".
4. Select "Update".

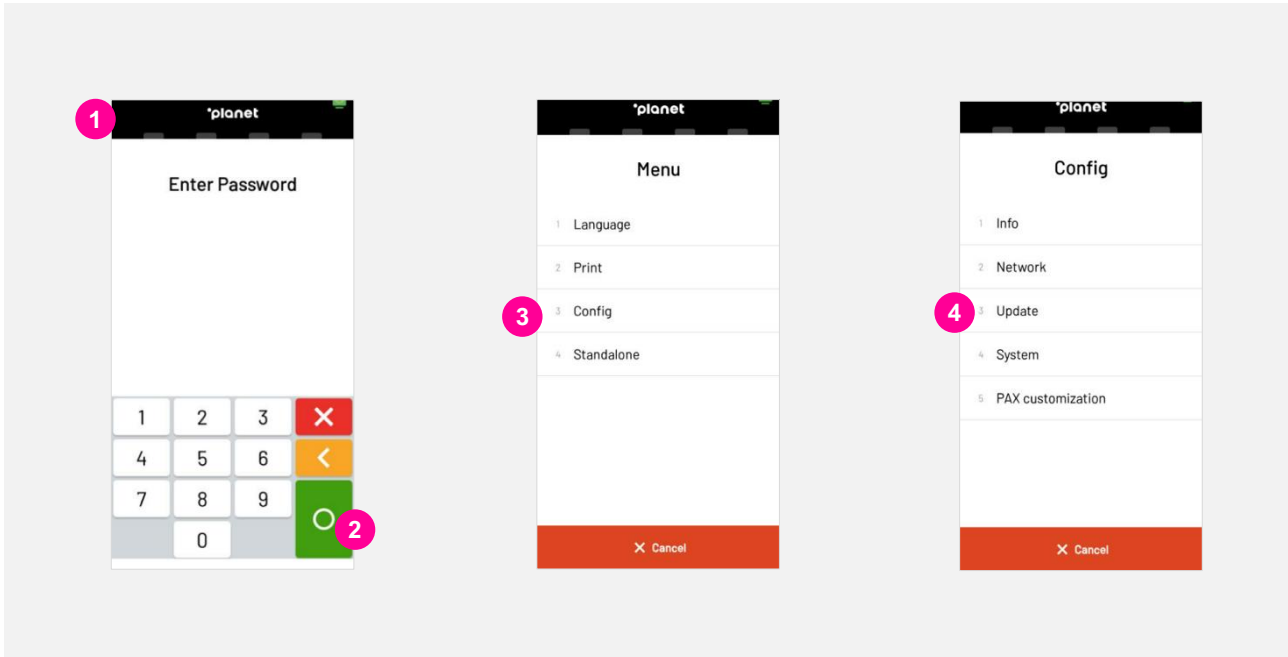

5. Select "Config".
6. Verify "TMS TID" and select the green button
7. Terminal will display "configuration download in progress".

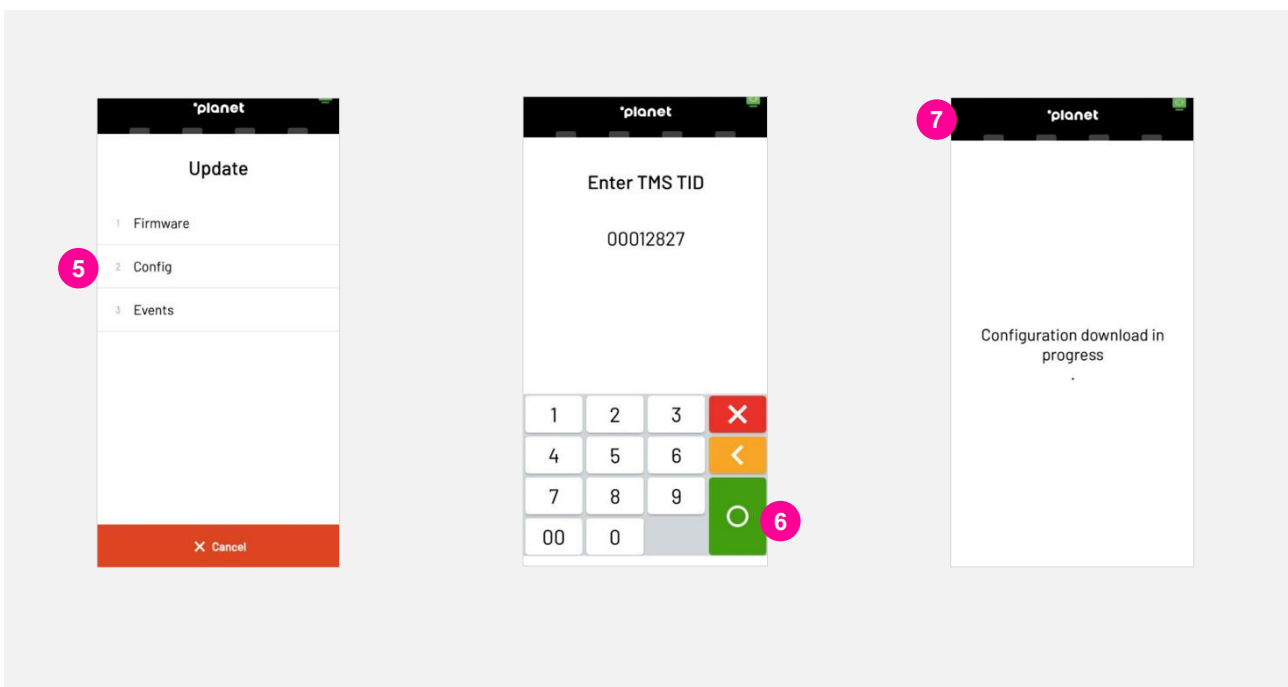

8. Should your Terminal not have any configuration updates available it will display “No new configuration available”

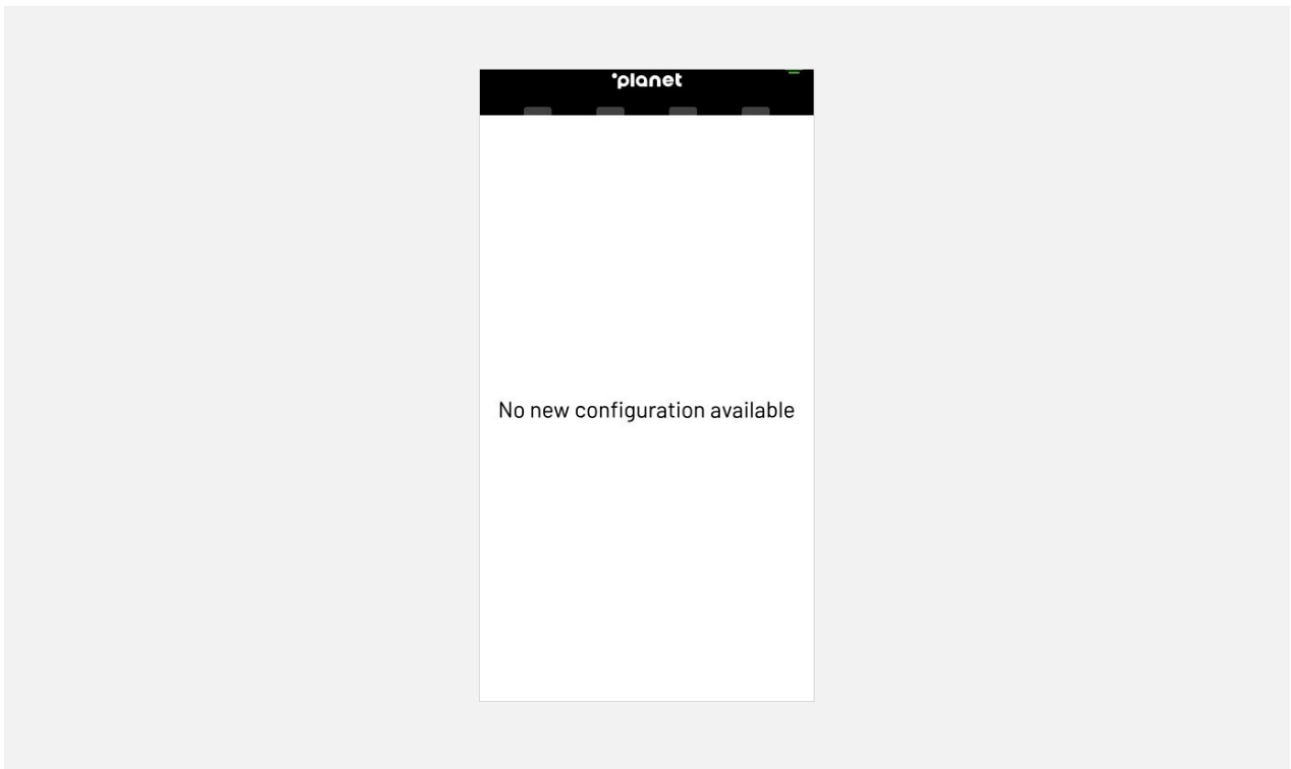

9. Contact Us



Need help?

If you have a technical issue or need support troubleshooting, please check the relevant portal for assistance.

Our Global Support Team will be glad to help.

Visit www.weareplanet.com/support

Disclaimer:

The procedures included in the document are only valid for brand new terminals. Terminals used beforehand may behave differently.